

## Chipping Norton, NSW

61 Wolverton Avenue

5  
BED

2  
BATH

2  
CAR

RealEquity  
estate agents

Located in a fantastic street in the popular lakeside area of Chipping Norton is this impeccably presented family residence. Offering comfortable and spacious living with beautiful sun-infused interiors, this delightful home suits growing families looking for an entertainers lifestyle in a family-friendly neighbourhood.

#### A Few Inviting Features:

- Attractive facade with well-manicured gardens & lawns
- Massive sunken formal lounge room with fireplace upon entry
- Open retreat/reading area off the study

**\$1150 pw**

**Contact:** Investment Management Team  
0297554222

**Type:** House

**Date Available:** 20/07/2024

**<https://www.realequity.com.au>**

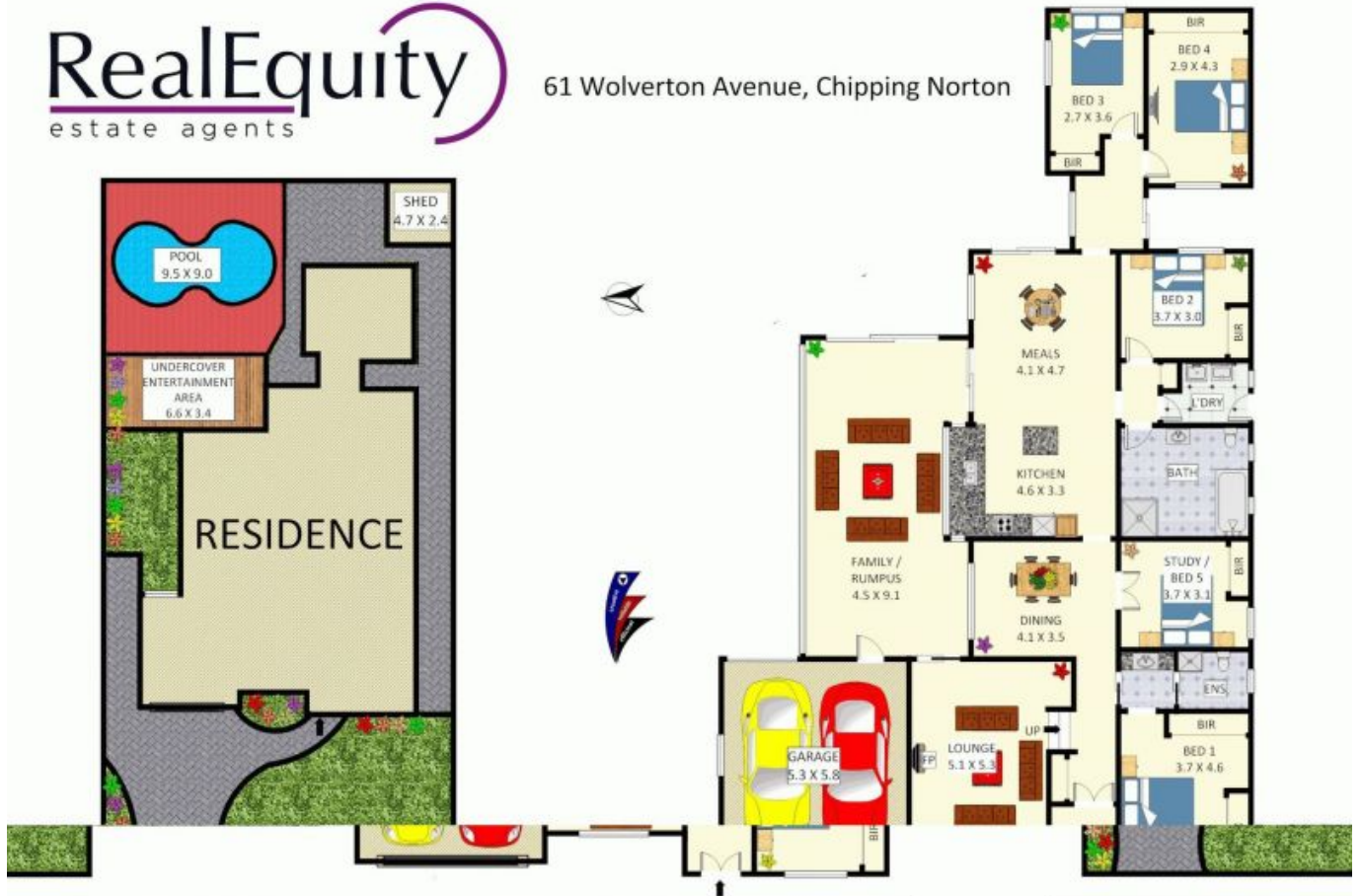

for purposes and are not part of any legal document. All measurements and figures are approximate. Floor Plans by MUS: 0404 538 655

Disclaimer: Plans shown are for presentation purposes only.

Plans shown are only indicative of layout. Dimensions are approximate.

**Chipping Norton, NSW**  
61 Wolverton Avenue