



PYRMONT, NSW
509/1 Wattle Crescent

2 BED **2** BATH **1** CAR



Drenched in natural sunlight with a unrivalled aspect overlooking Blackwattle Bay and the iconic Anzac Bridge, this lavish apartment has been meticulously finished with stylish high quality inclusions..

- A Few Inviting Features:
- Inviting foyer with automatic glass door
 - Combined living spaces with stunning views
 - Designer kitchen with Miele appliances
 - Stunning bathroom with chic lux finishes
 - Master bedroom, built in robe & ensuite
 - 2nd bedroom accessing the balcony

SOLD!
Contact: Anthony Prestia
 02 9755 4222
 0414 775 577
 Joshua Prestia
 02 9755 4222
 0404 252 695
Type: Unit
Sold Date: 29/09/2021
Land: 81m2
<https://www.realequity.com.au>

5.09/1 Wattle Crescent, Pyrmont

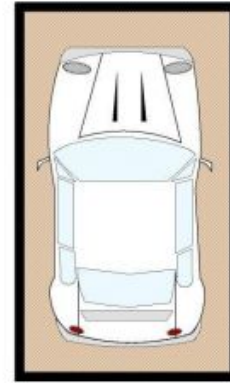
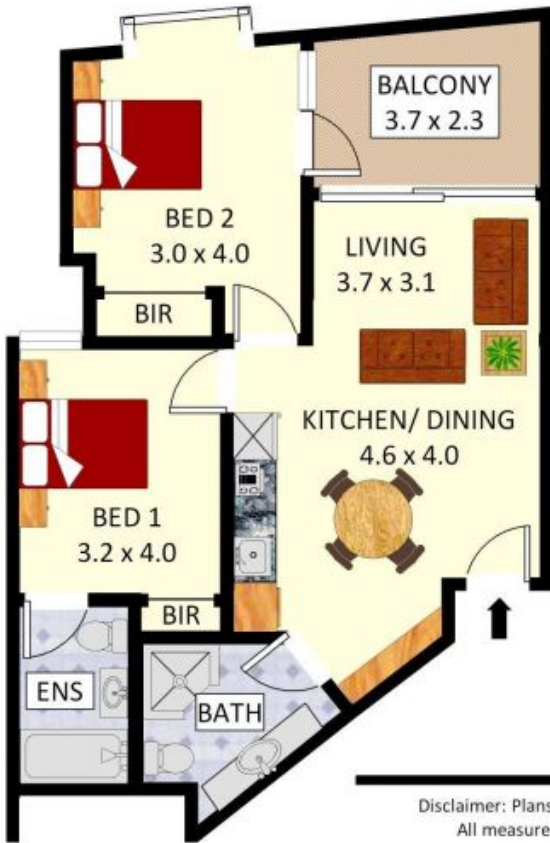

1 X CAR SPACE
3.0 x 5.6

Disclaimer: Plans shown are for presentation purposes and are not part of any legal document.
All measurements and figures are approximate. Floor Plans by FARRIS: 0455 905 945

Plans shown are only indicative of layout. Dimensions are approximate.

PYRMONT, NSW
509/1 Wattle Crescent