



Chipping Norton, NSW
25 Aylesbury Crescent

4 BED **2** BATH **2** CAR



This exceptional residence has recently had a makeover that will leave you with a lasting impression. From the very first step you are greeted with a stylish open plan design, chic designer kitchen with stone bench tops, an abundance of entertaining areas and a sparkling inground pool all stretched over one generous level, this immaculate residence caters for the whole family and is perfect place to home.

Features:

- Double timber door entrance leading to open style living
- Gourmet kitchen with stone benchtops and island bench
- Gas cooking, stainless steel appliances, plenty of bench space

SOLD!

Contact: Anthony Prestia
02 9755 4222
0414 775 577
Antonio Furfaro
02 9755 4222
0455 077 861

Type: House
Sold Date: 27/03/2020

Land: 670m2
<https://www.realequity.com.au>

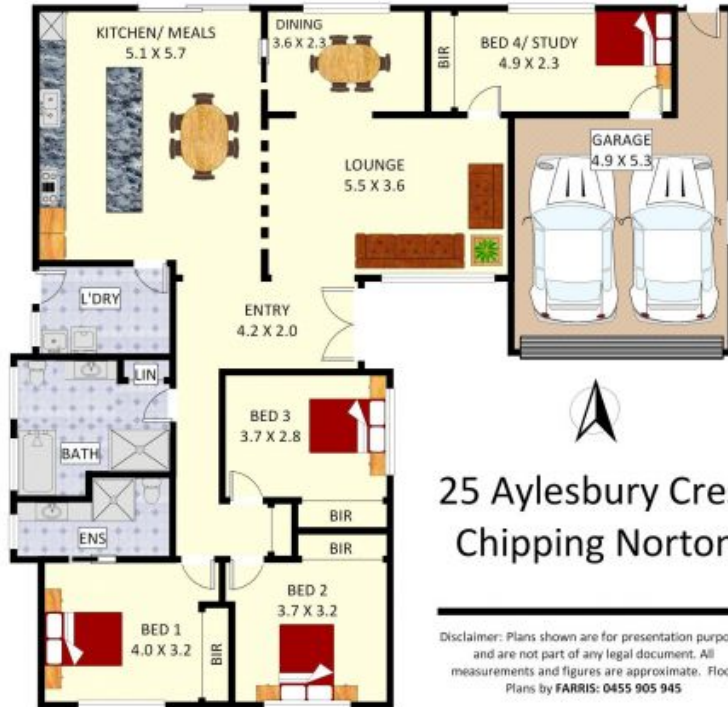

25 Aylesbury Cres,
Chipping Norton

Disclaimer: Plans shown are for presentation purposes and are not part of any legal document. All measurements and figures are approximate. Floor Plans by FARRIS: 0455 905 945



Plans shown are only indicative of layout. Dimensions are approximate.

Chipping Norton, NSW
25 Aylesbury Crescent