



Chipping Norton, NSW

28 Aylesbury Crescent

4
BED

2
BATH

2
CAR

RealEquity
estate agents

Offering excellent living spaces that complement the superb presentation, this comfortable family residence is ideal for the homebuyer seeking absolute privacy along with the scope to add your own taste if desired.

Features:

- 4 good sized bedrooms, built in robes
- Master with well kept en-suite
- L shaped formal lounge and dining areas
- Open plan kitchen overlooking family room
- Excellent 3 way bathroom
- Laundry with external access

SOLD \$855,000

Contact: Joshua Prestia
02 9755 4222
0404 252 695
Anthony Prestia
02 9755 4222
0414 775 577

Type: House
Sold Date: 14/10/2015
Land: 662m2
<https://www.realequity.com.au>

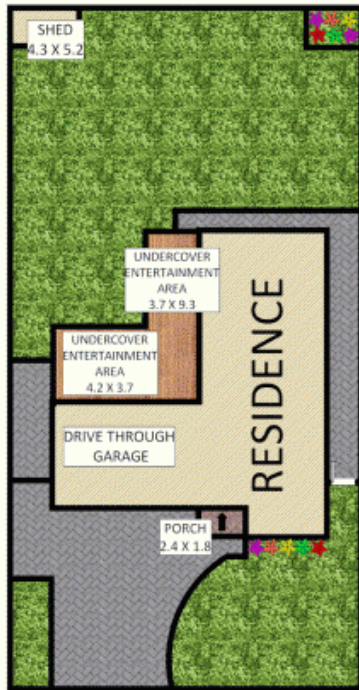

Disclaimer: Plans shown are for presentation purposes and are not part of any legal document. All measurements and figures are approximate. Floor Plans by MUS: 0404 538 655

Plans shown are only indicative of layout. Dimensions are approximate.

Chipping Norton, NSW
28 Aylesbury Crescent