



Chipping Norton, NSW

23/7 Mead Drive

3 BED
2 BATH
1 CAR

RealEquity
estate agents

This lovely lakeside apartment captures the essence of resort style living whilst soaking in the afternoon sun. Offering an excellent floorplan that stretches over approx 110m2, this top floor residence is perfect for a first homebuyer or investor to purchase an excellent property in a superb location.

Features:

- 3 good sized bedrooms, built ins
- Master with a neat ensuite
- Generous size lounge and dining areas
- Attractive bathroom, floor to ceiling tiles

Offers over \$490,000

Contact: Joshua Prestia
02 9755 4222
0404 252 695
Anthony Prestia
02 9755 4222
0414 775 577

Type: Unit
Sold Date: 17/07/2015
Land: 110m2
<https://www.realequity.com.au>

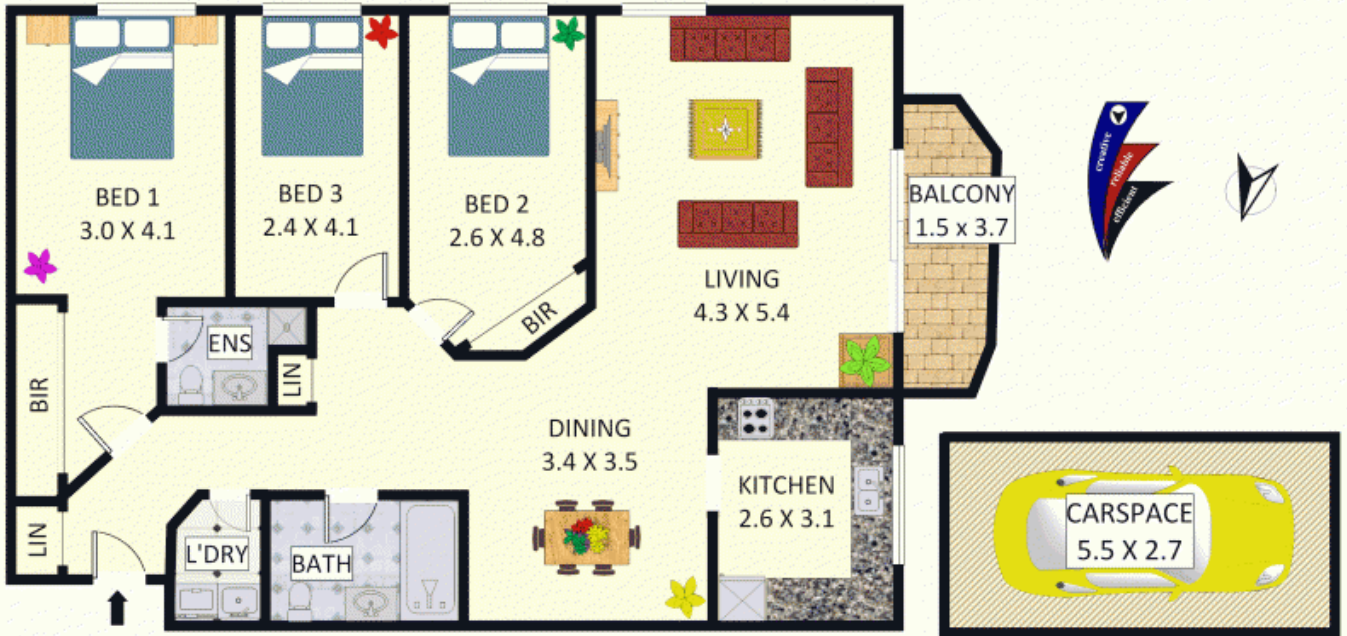

Disclaimer: Plans shown are for presentation purposes and are not part of any legal document. All measurements and figures are approximate. Floor Plans by MUS: 0404 538 655

Plans shown are only indicative of layout. Dimensions are approximate.

Chipping Norton, NSW
23/7 Mead Drive