



Chipping Norton, NSW

58 Wolverton Avenue

5
BED

3
BATH

2
CAR

RealEquity
estate agents

Ideal for the Family ??? Perfect Lakeside Position

Enjoying an exclusive location that is only 50 metres to Chipping Norton Park and Lake, the lovely wide street with beautifully maintained homes makes for an inviting setting to locate your family or perhaps entertain your friends.

Features

- 5 good sized bedrooms, built in robes
- 3 bathrooms with floor to ceiling tiles
- Large separate lounge area

SOLD \$890,000

Contact: Joshua Prestia
02 9755 4222
0404 252 695

Type: House
Sold Date: 22/01/2014
Land: 704m2

<https://www.realequity.com.au>



Real Equity

FIRST NATIONAL | Chipping Norton

58 Wolverton Avenue,
Chipping Norton



GROUND FLOOR



FIRST FLOOR

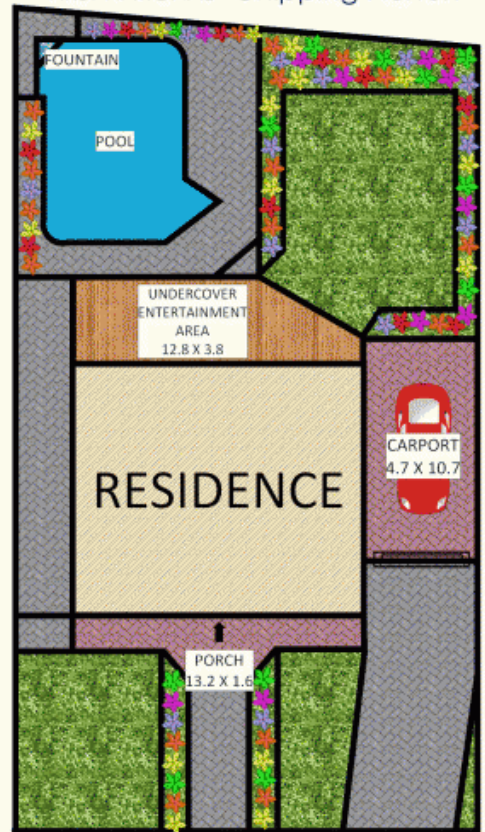

Disclaimer: Plans shown are for presentation purposes and are not part of any legal document. All measurements and figures are approximate. Floor Plans by MUS: 0404 538 655

Plans shown are only indicative of layout. Dimensions are approximate.

Chipping Norton, NSW
58 Wolverton Avenue